

ARP T 50 Series

“Magnetic Non-Contact Measurement,
50 mm Body Diameter”

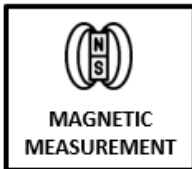
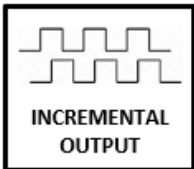

- Non-contact measurement with magnetic principle
- Incremental output
- 50 mm body diameter
- Resolution options between 1 pulse and 1024 pulses
- Operating speed up to 20.000 RPM
- Standard IP54, optional IP67 protection class
- High sensitivity
- Robust structure, long service life

ARP T 50 series rotary encoders measure with magnetic principle and work contactless.

They consist of 2 parts, the encoder body and magnet. They have long operating life as they make non-contact measurement. They can also operate at high speeds up to 20,000 RPM. They work incrementally and offer resolution up to 1024 pulses.

Standard IP54, optionally IP67 protection class is available.

MECHANICAL DATA

Dimensions	Encoder: $\varnothing 50$
	Rotor: $\varnothing 27$
Material	Aluminum
Weight	Encoder: ~180g
	Rotor: ~10g

ENVIRONMENTAL DATA

Protection Class	IP54 (Optional IP67)
Operating Temp.	-25°C...+85°C
Storage Temp.	-40°C...+100°C

ELECTRICAL DATA

Measuring Type	Magnetic, non-contact						
Resolution	All resolution values between 1 and 1024 pulses						
Operating Speed	20.000 RPM max.						
Response Frequency	300 KHz						
Current Consumption	50 mA nominal						
Supply and Output Type		PP	TTL	HTL	HPL	OCL	OCP
	Supply	10...30 VDC	5 VDC	10...30 VDC	5...30 VDC	The supply signal should not be lower than the output signal	
	Output	10...30 VDC PP	5 VDC TTL	5 VDC TTL	5...30 VDC PP	NPN Open Collector	PNP Open Collector
Output Signals	A, /A, B, /B, Z, /Z						
Output Current	100 mA max. (per channel)						
Electrical Connection	5 x 0,14mm ² shielded cable (outer diameter: 5 ±0,2 mm) (When output signal is selected as 2 or 3) 8 x 0,14mm ² shielded cable (outer diameter: 6,5 ±0,2 mm) (When output signal is selected as 4 or 6)						

ELECTRICAL CONNECTION

SIGNAL	CABLE COLOR
A	YELLOW
/B	WHITE
+V	RED
0 V	BLACK
/A	BLUE
B	GREEN
/Z	GREY
Z	PINK

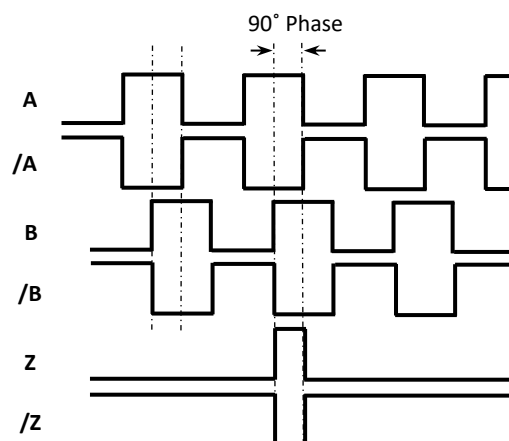

The table above shows the cable colors of the sensor output signals. If the control circuit is suitable in the Line Driver sensors of the not output signals (/A, /B, /Z) have to be added to the system. If it is not suitable /A, /B, /Z signal cables must be fixed as insulated separately. Don't forget that these edges have electricity too.

MECHANICAL DIMENSIONS (mm)

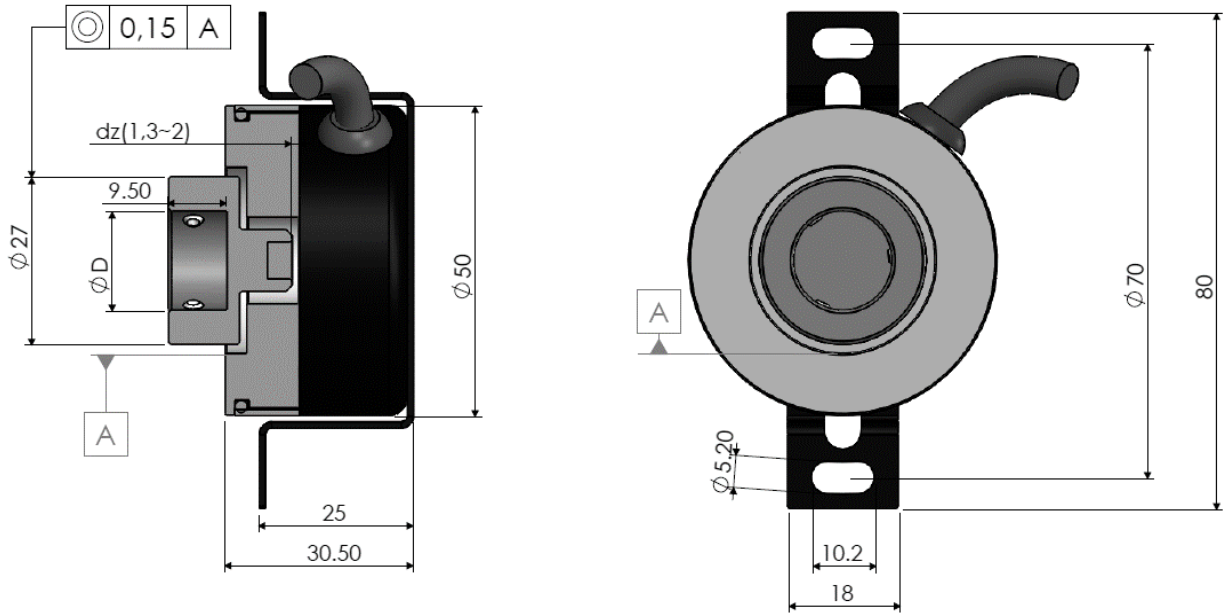

$\varnothing D$ = Options from 5mm to 16mm

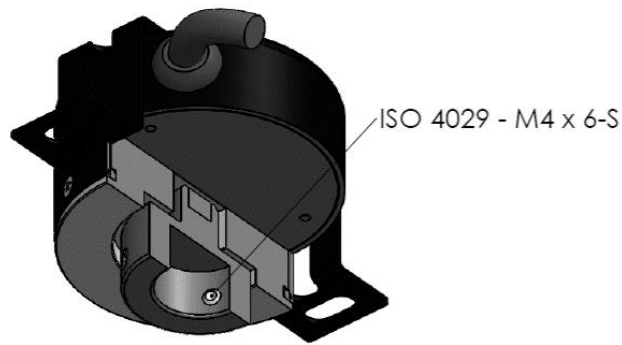

ORDER CODE

Model	Type	Body Diameter	Resolution	Supply and Output	Electrical Connection	Cable Direction	Hollow Diameter
ARP	T	XXX	XXXX	XXX	X	XX	X
	T : Non-contact	050 : 50 mm	All resolution values between 1 and 1024 pulses are available	Output Signals 2 (A,B) 3 (A,B,Z) 4 (A,/A,B,/B) 6 (A,/A,B,/B,Z,/Z)	Electrical Connection 2M : 2m cable *Optional others	Y : From side	Hollow Diameter Different hollow diameters between 5mm and 16mm *Optional others